

APPENDIX 1 - A50 / STATION ROAD (COUNTY HALL) ROUNDABOUT

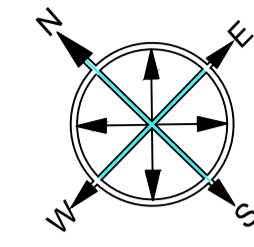

- Key**
- Proposed Toucan Crossing (Shared Pedestrian and Cycle Crossing)
 - Proposed Pedestrian & Cycle Crossing Point
 - Existing Off Road Segregated Cycle Route
 - Existing Off Road Shared Use Cycle Route
 - Proposed Off Road Shared Use Cycle Route
 - Improved Footway
 - New Kerbline
 - New lining
 - Proposed New Carriageway
 - Proposed New Footway

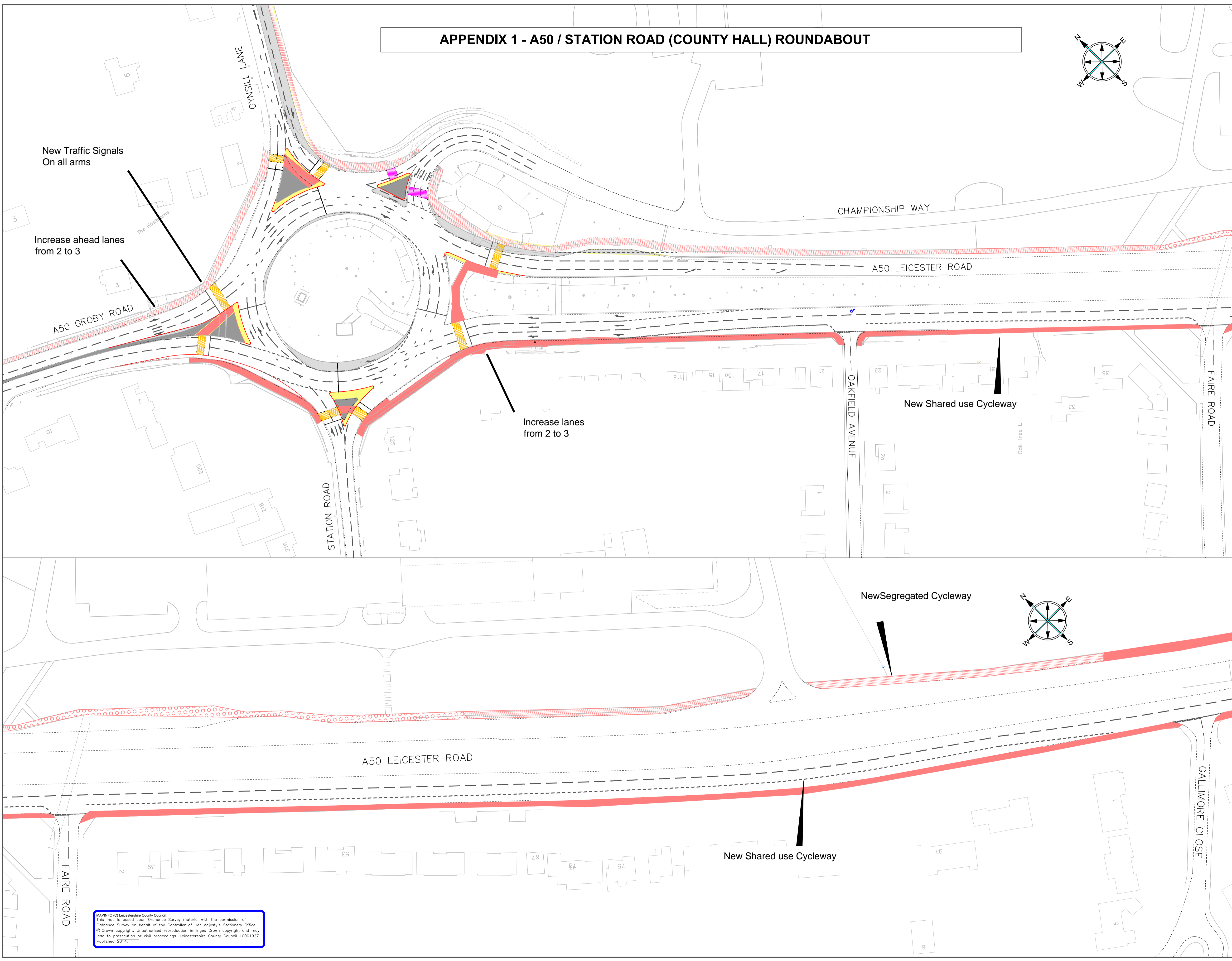

MAPINFO (C) Leicestershire County Council
 This map is based upon Ordnance Survey material with the permission of Ordnance Survey on behalf of the Controller of Her Majesty's Stationery Office
 © Crown copyright. Unauthorised reproduction infringes Crown copyright and may lead to prosecution or civil proceedings. Leicestershire County Council 100019271.
 Published 2014.

Leicester City Council
 Leicestershire County Council

CLIENT: LEICESTER NORTH WEST TRANSPORT PROJECT

TITLE: PREFERRED PROPOSALS A50 STATION ROAD (COUNTY HALL) ROUNDABOUT

DRAWING NUMBER	SCALE
0031A1/PD1	NOT TO SCALE
PREPARED BY: D YOUNGA DUNN	DATE: 11/02/2015
CHECKED BY: C WARDLE	SIZE: A1
APPROVED BY: L QUINCY	CORR FILE: